



INSTRUCTIONS

6+

Please keep these instructions for future reference as they contain important information.

1 CONTENTS

Each set includes: 1 warrior, 1 ripcord, 1 set of spincissors.

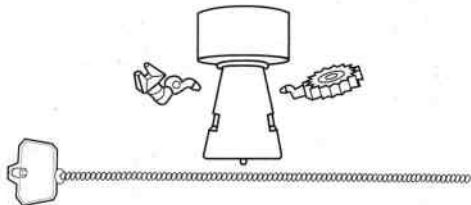

WARNING: Do not aim at eyes or face. Only use projectiles supplied with this toy. Do not fire at point blank range.

2 ASSEMBLY

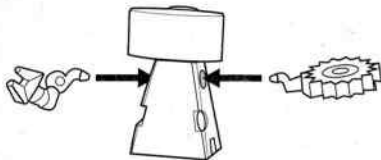

You can customize your warrior by attaching spincissors from other VS Rip-Spin Warriors™ (sold separately).

©2016 Mattel. All Rights Reserved. Mattel East Asia Ltd., Room 503-09, North Tower, World Finance Centre, Harbour City, Tsimshatsui, HK, China. Diimport & Diedarkan Oleh: Mattel SEA Ptd Ltd. (993532-P) Lot 13.5, Menara Lien Hoe, Persiaran Tropicana Golf Country Resort, 47410 PJ, Malaysia. Tel: 03-78803817, Fax: 03-78803867.



DRH88-0970	DTC73-0970	DRH92-0970	DRH93-0970
1100852582_DOM	1100852582_DOM	1100852582_DOM	1100852582_DOM
DRH89-0970	DRH95-0970	DRH98-0970	DRH94-0970
1100852582_DOM	1100852582_DOM	1100852582_DOM	1100852582_DOM
DRH90-0970	DRH96-0970	DTC72-0970	DTC75-0970
1100852582_DOM	1100852582_DOM	1100852582_DOM	1100852582_DOM
DRH91-0970	DRJ49-0970	DRH97-0970	DRH99-0970
1100852582_DOM	1100852582_DOM	1100852582_DOM	1100852582_DOM
DTC74-0970	DRJ50-0970	DRJ51-0970	DRP72-0970
1100852582_DOM	1100852582_DOM	1100852582_DOM	1100852582_DOM

3 TO SPIN

A. Insert ripcord from either side of the warrior.

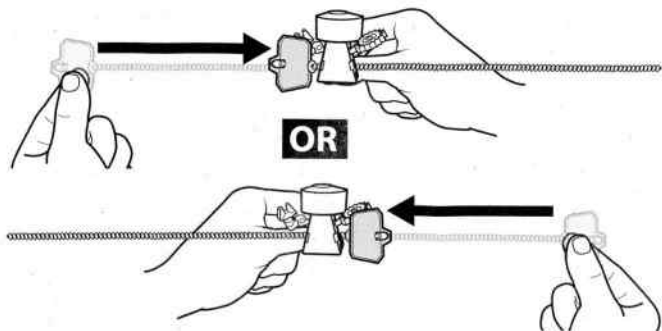

B. Holding the warrior in one of the ways shown, swiftly pull the ripcord out.

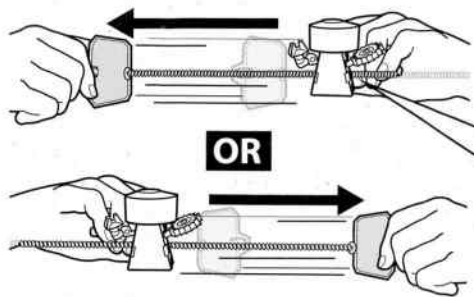

BACK VIEW

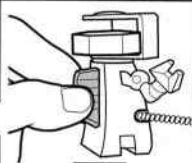

OR



HOLD LIKE THIS TO
PULL RIPCORD WITH
MORE POWER.

C. Release warrior and see it spin!



4 TO BATTLE

- A.** Place warriors on the Battle Arena's launch points.

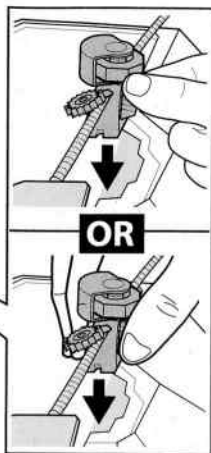
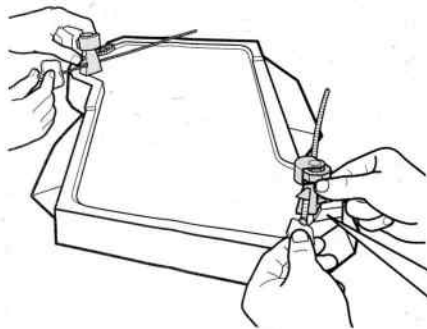

Battle Arena and additional warriors sold separately, subject to availability.

- B.** Release warriors together! Spin into action and battle!

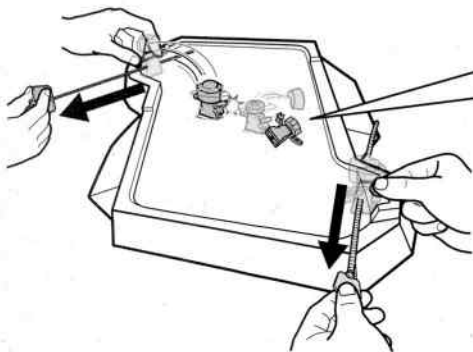

REATTACH WARRIOR'S FACE IF IT COMES OFF DURING BATTLE.

5 MORE WAYS TO PLAY

A. Warriors can spin on their head!

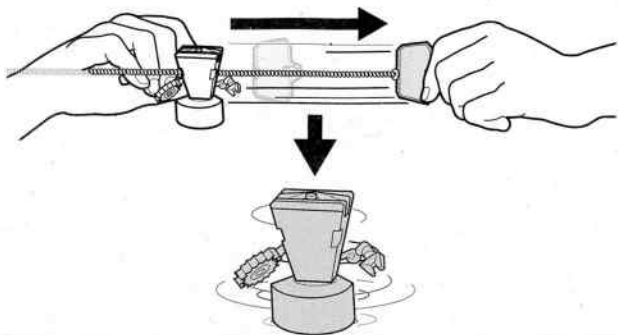

B. Tilted spins! Lean the warrior to one side and release!

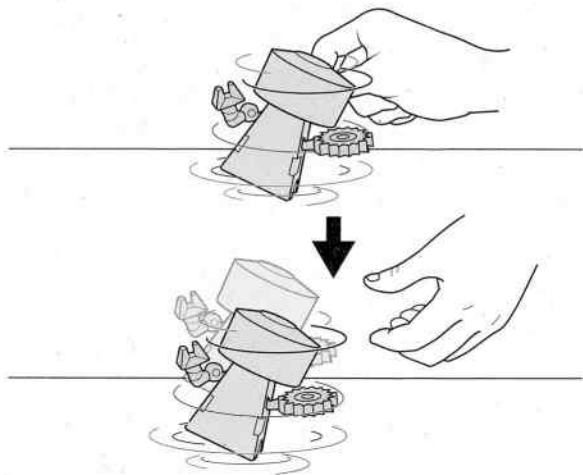

NOTE: For best performance, adjust the positions of spincessories before inserting ripcord.